

How To Reset Windows Password

Using college computer to reset your
Windows/Email password
(Windows 10 system used to create
screenshots.)

Password Standards

Password creation must have the following characteristics:

1. Contain at least three of the four following character classes:
 - a. Lower case characters
 - b. Upper case characters
 - c. Numbers
 - d. Punctuation
2. Contain at least eight characters.

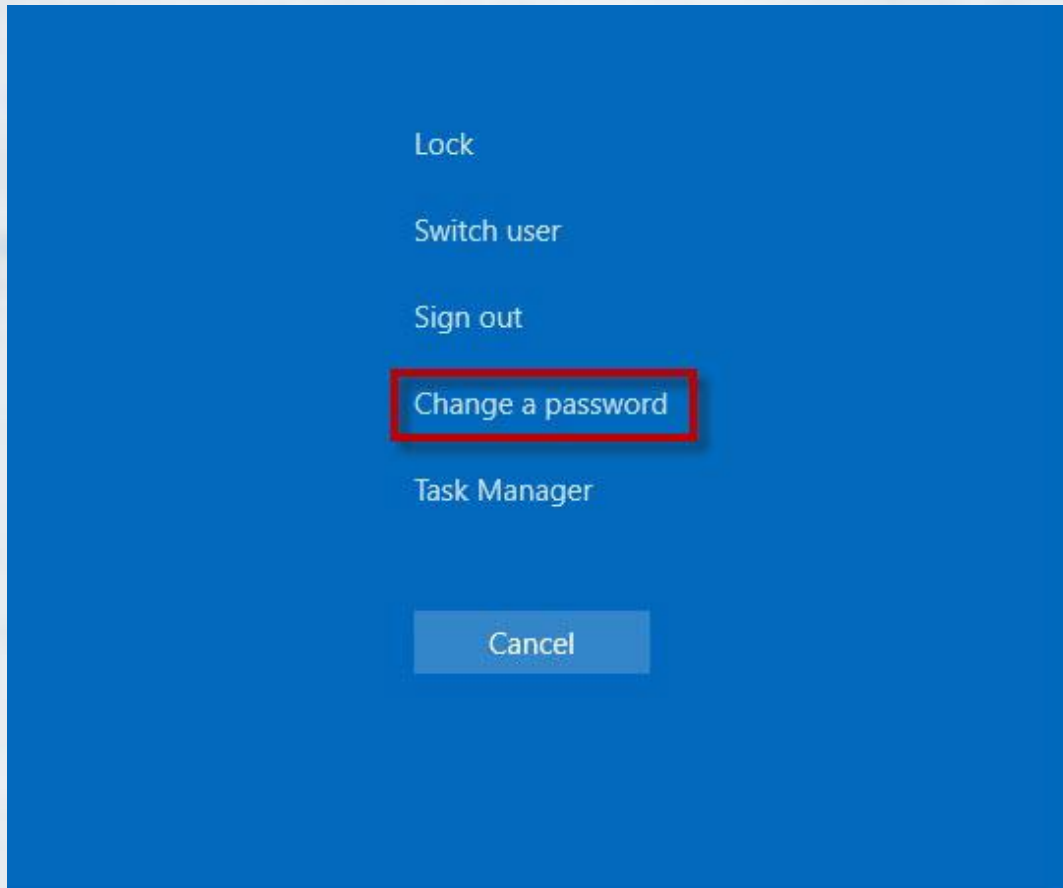

After login click Ctrl+Alt+Del.
Select "Change a password..."

Change a password

first.lastname@mgccc.edu

Old password

New password

Confirm password →

Sign in to: mgccc.edu

How do I sign in to another domain?

Sign-in options

Cancel

A screenshot of a web form titled "Change a password" set against a background image of a beach with large rock formations. The form contains four input fields: a text field with the placeholder "first.lastname@mgccc.edu", a field labeled "Old password", a field labeled "New password", and a field labeled "Confirm password" with a right-pointing arrow. A red rectangular box highlights these four input fields. Below the fields are the labels "Sign in to: mgccc.edu", "How do I sign in to another domain?", and "Sign-in options". At the bottom is a "Cancel" button.

Ensure your user name is in the top field.
Enter your old password and the new
password twice and click enter.

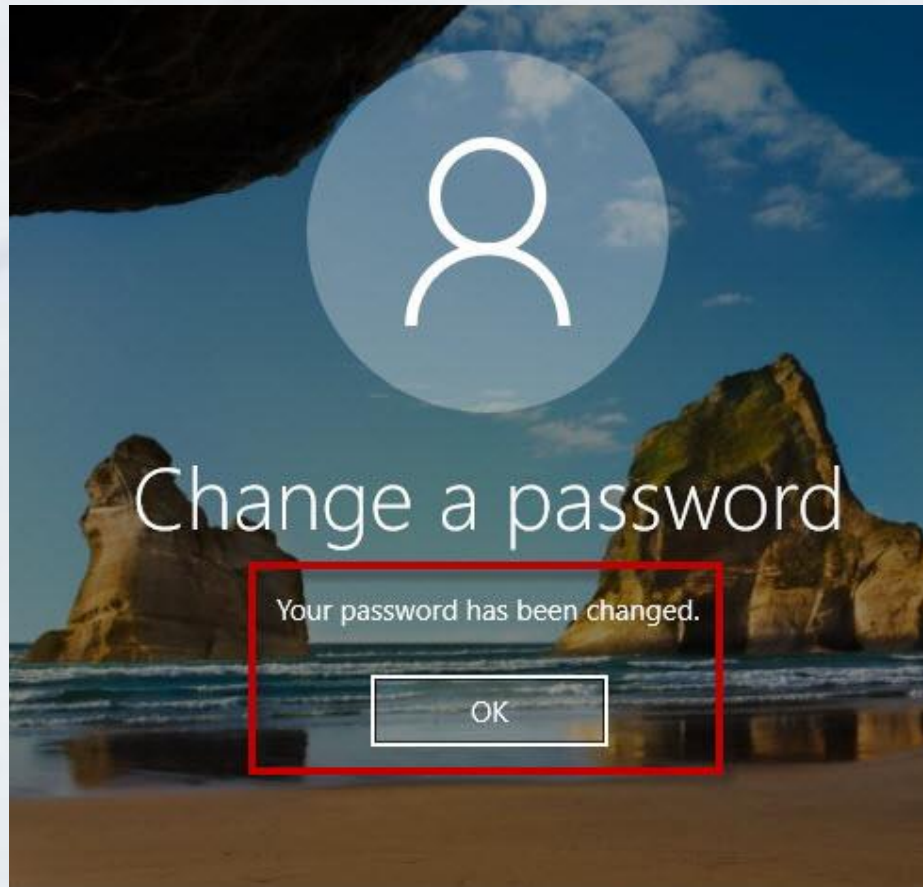

Your password has been changed.
Click "OK" and your done.